

CITY OF ANTIOCH
PUBLIC WORKS DEPARTMENT
NEIGHBORHOOD TRAFFIC CALMING PROJECT
P.W. 282-19A

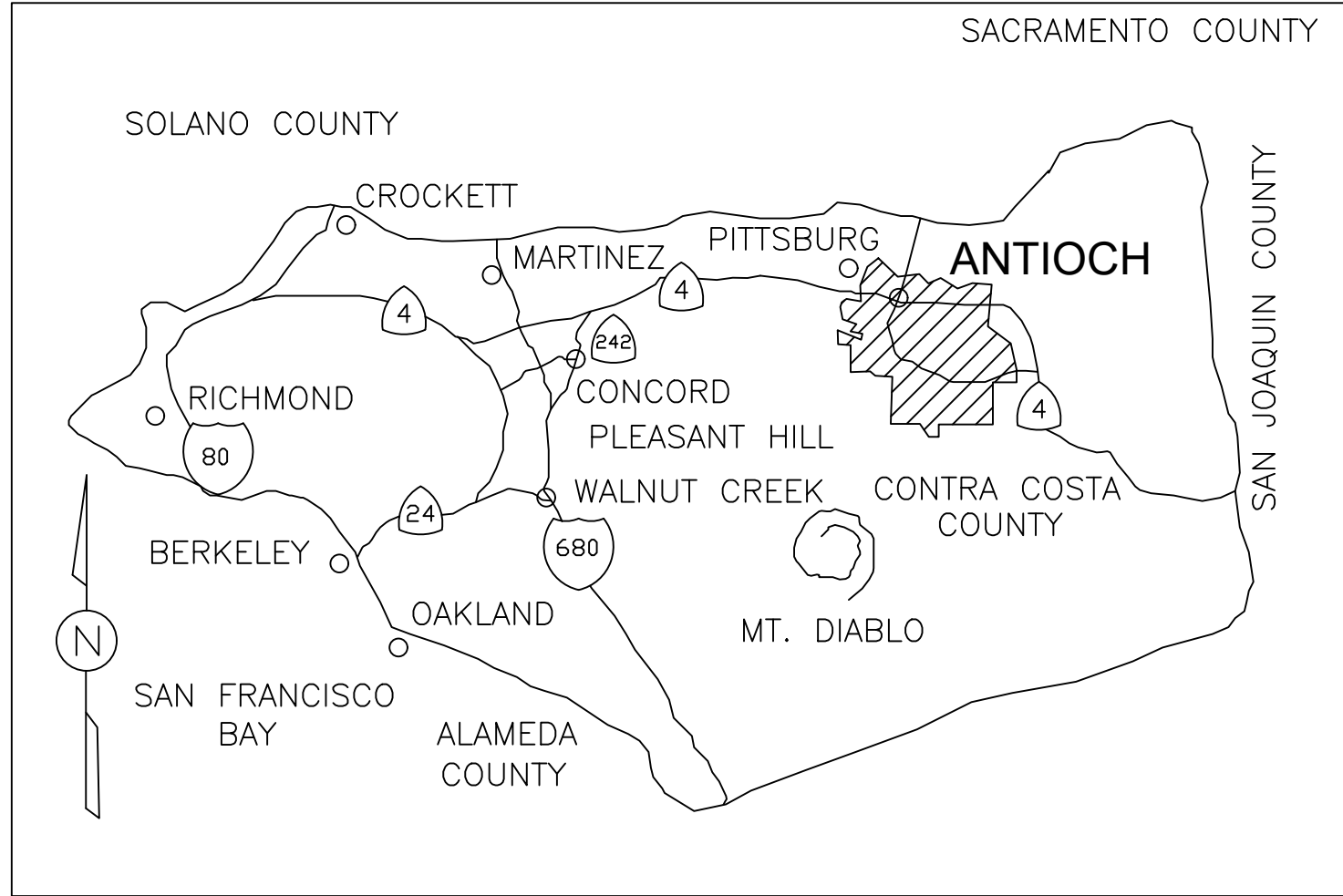

VICINITY MAP

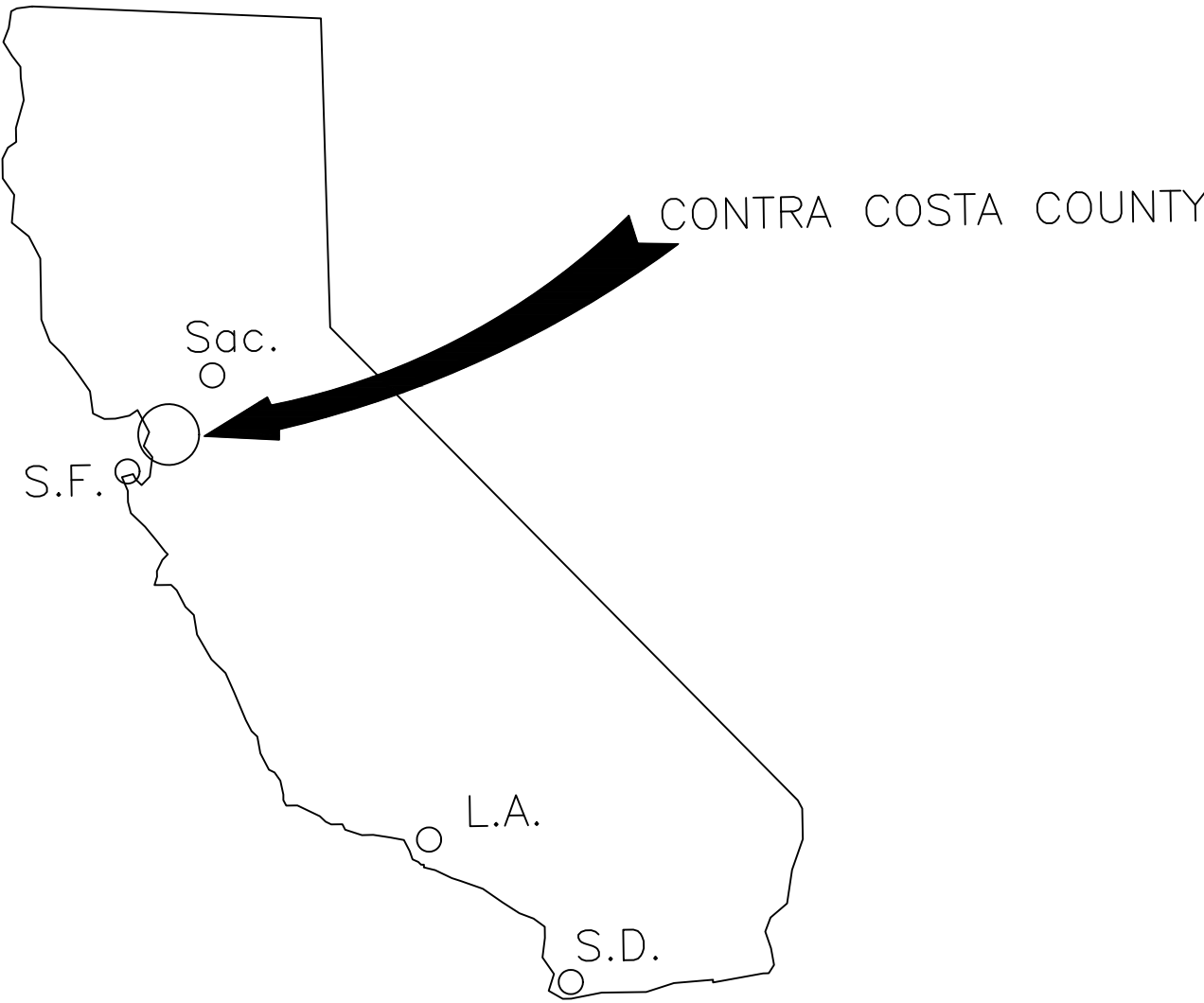

SHEET INDEX

SHEET NUMBER	DESCRIPTION
1	TITLE SHEET
2	GENERAL NOTES & DETAILS
3	2ND STREET
4	TULIP DRIVE
5	GENTRYTOWN DRIVE (1)
6	GENTRYTOWN DRIVE (2)
7	LONGVIEW ROAD
8	CLEARBROOK ROAD
9	GARROW DRIVE
10	ASILOMAR DRIVE
11	PREWETT RANCH DRIVE (1)
12	PREWETT RANCH DRIVE (2)
13	COUNTRY HILLS DRIVE
14	DEERFIELD DRIVE

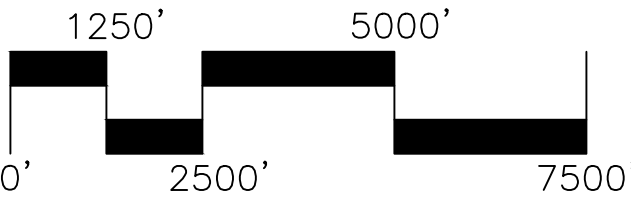
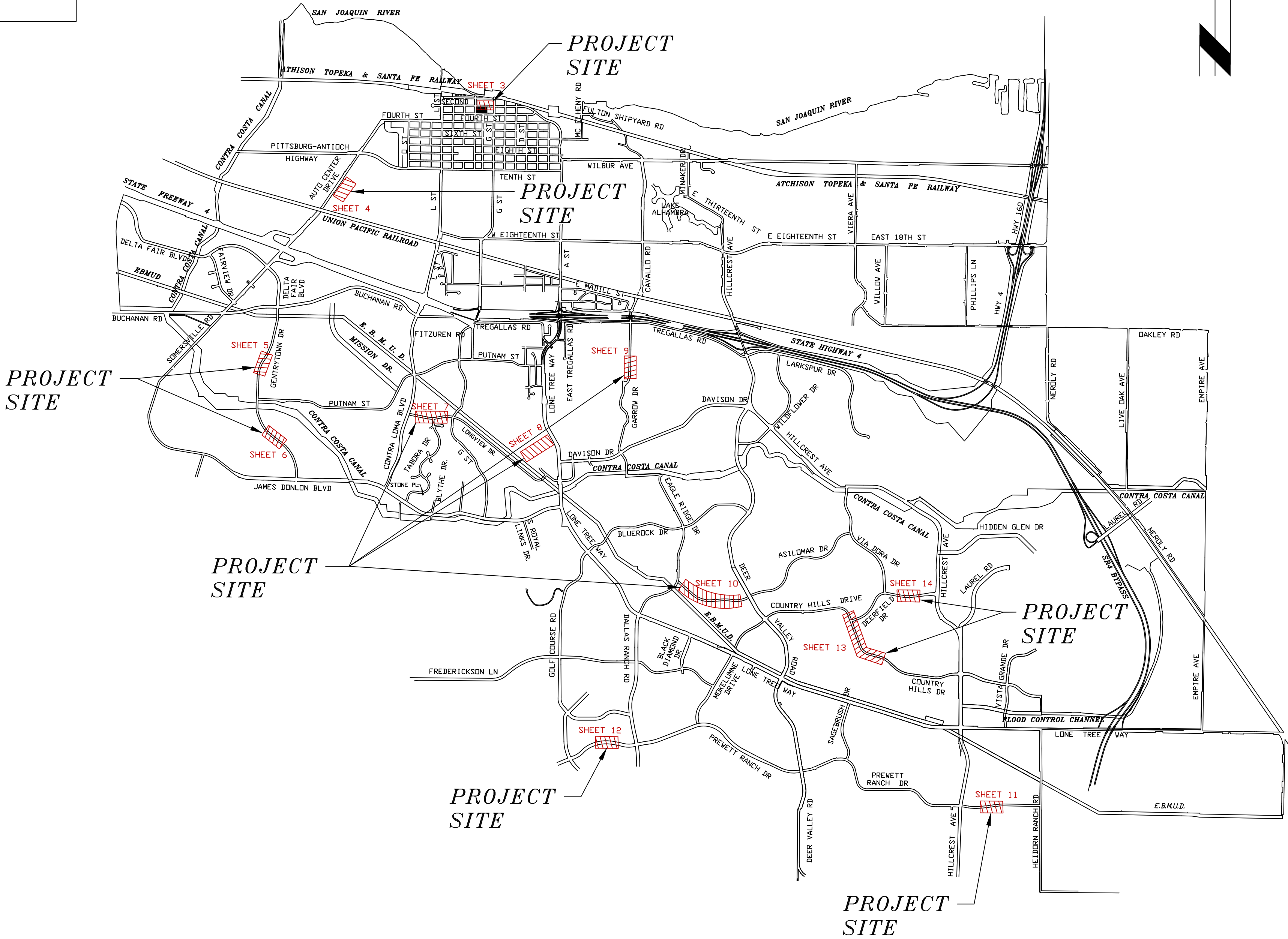

GENERAL NOTES

1. ALL CONSTRUCTION AND MATERIALS SHALL BE IN ACCORDANCE WITH THE LATEST EDITIONS, INCLUDING ALL UPDATES, OF THE CITY OF ANTIOCH STANDARD SPECIFICATIONS, THE CALTRANS STANDARD PLANS AND SPECIFICATIONS, THE CAMUTCD, AND WITH THE SPECIAL PROVISIONS FOR THE PROJECT.
2. THE STANDARD DRAWINGS OF THE CITY OF ANTIOCH STANDARDS AND SPECIFICATIONS SHALL SUPERSEDE THOSE OF THE CALTRANS STANDARD SPECIFICATIONS WHERE DISCREPANCIES EXIST.
3. THE CONTRACTOR SHALL NOT PROCEED WITH ANY WORK CALLED FOR ON THESE PLANS UNTIL THE CITY ENGINEER'S SIGNATURE OF APPROVAL IS AFFIXED HEREON AND ALL APPLICABLE PERMITS HAVE BEEN OBTAINED. AN APPROVED SET OF PLANS SHALL BE ON THE JOB SITE DURING ANY CONSTRUCTION.
4. THE CONTRACTOR SHALL BE RESPONSIBLE FOR REPORTING ALL CONFLICTS, ERRORS, OMISSIONS ETC, TO THE ENGINEER IMMEDIATELY UPON DISCOVERY, IF SO DIRECTED BY THE ENGINEER, THE CONTRACTOR SHALL STOP WORK UNTIL REMEDIAL ACTION CAN BE TAKEN. ANY COST RESULTING FROM THE CONTRACTOR'S FAILURE TO REPORT OR FAILURE TO STOP WORK AS DIRECTED WILL BE THE RESPONSIBILITY OF THE CONTRACTOR.
5. THE CONTRACTOR SHALL ASSUME SOLE AND COMPLETE RESPONSIBILITY FOR THE JOB SITE CONDITIONS DURING THE COURSE OF CONSTRUCTION, INCLUDING SAFETY OF ALL PERSONS AND PROPERTY. THIS REQUIREMENT SHALL APPLY CONTINUOUSLY AND NOT BE LIMITED TO NORMAL WORKING HOURS. THE CONTRACTOR SHALL DEFEND, INDEMNIFY AND HOLD THE OWNER AND ENGINEER HARMLESS FROM ANY AND ALL LIABILITY, REAL OR ALLEGED, IN CONNECTION WITH THE PERFORMANCE OF WORK ON THIS PROJECT, EXCEPT FOR LIABILITY ARISING FROM THE SOLE NEGLIGENCE OF THE OWNER OR ENGINEER.
6. THE CONTRACTOR SHALL CONTACT THE CITY OF ANTIOCH PUBLIC WORKS DEPARTMENTS TO SCHEDULE A PRE-CONSTRUCTION MEETING OF AT LEAST TEN (10) WORKING DAYS PRIOR TO THE START OF ANY CONSTRUCTION.
7. THE CONTRACTOR SHALL MAKE AN ON-SITE INSPECTION PRIOR TO PROVIDING ANY PROPOSALS TO DETERMINE ANY AND ALL ITEMS NOT SHOWN AS BID ITEMS ON THE PROPOSAL SHEETS, BUT WHICH MAY BE NECESSARY TO PERFORM A COMPLETE AND ACCEPTABLE JOB.
8. THE LOCATIONS OF ALL UNDERGROUND FACILITIES SHOWN ON THIS PLAN ARE APPROXIMATE. A REASONABLE EFFORT HAS BEEN MADE TO LOCATE AND DELINEATE ALL UNDERGROUND FACILITIES. THE CONTRACTOR SHALL VERIFY THE LOCATION OF ALL EXISTING FACILITIES AND IMMEDIATELY NOTIFY THE ENGINEER IF ANY SUCH FACILITIES INTERFERE WITH THE CONSTRUCTION IMPROVEMENTS.
9. THE CONTRACTOR IS HEREBY NOTIFIED THAT PRIOR TO COMMENCING CONSTRUCTION HE IS RESPONSIBLE FOR CONTRACTING ALL UTILITY COMPANIES FOR VERIFICATION AT THE CONSTRUCTION SITE OF THE LOCATIONS OF ALL UNDERGROUND FACILITIES WHERE SUCH FACILITIES MAY CONFLICT WITH PLACEMENT OF IMPROVEMENTS SHOWN ON THIS PLAN. CALL "UNDERGROUND SERVICE ALERT" AT 800-422-4133 PRIOR TO ANY EXCAVATION.
10. ALL SALVAGED SIGNS AND EQUIPMENT SHALL BE DELIVERED TO THE CITY OF ANTIOCH CORPORATE YARD, CONTRACTOR SHALL SCHEDULE DELIVERIES A MINIMUM OF 24 HOURS IN ADVANCE. CONTRACTOR SHALL BE RESPONSIBLE FOR UNLOADING ALL EQUIPMENT.
11. PUBLIC STREETS SHALL REMAIN OPEN AT ALL TIMES. NO DETOURING WILL BE ALLOWED.
12. THE CONTRACTOR WILL NOT BE ALLOWED TO ROUTE TRAFFIC ONTO ANY UNPAVED PORTION OF THE STREET. NO EXISTING PAVEMENT SHALL BE REMOVED UNTIL ALL NECESSARY TRAFFIC CONTROL DEVICES HAVE BEEN INSTALLED TO ROUTE TRAFFIC ONTO OTHER PAVED PORTIONS OF THE ROADWAY AND SUCH REMOVAL HAS BEEN APPROVED BY THE ENGINEER.
13. THE CONTRACTOR AGREES THAT IN ACCORDANCE WITH GENERALLY ACCEPTED CONSTRUCTION PRACTICES, THE CONTRACTOR SHALL BE REQUIRED TO ASSUME SOLE AND COMPLETE RESPONSIBILITY FOR JOB SITE CONDITIONS DURING THE COURSE OF CONSTRUCTION OF THIS PROJECT. THESE PLANS DO NOT INCLUDE COMPONENTS NECESSARY FOR CONSTRUCTION SAFETY. IT IS THE CONTRACTOR'S SOLE RESPONSIBILITY TO PROVIDE FOR THE SAFETY OF ALL PERSONS AND PROPERTY DURING THE COURSE OF CONSTRUCTION.
14. THE CONTRACTOR SHALL COMPLY WITH THE RULES AND REGULATIONS OF THE STATE CONSTRUCTION SAFETY ORDERS. THIS REQUIREMENT SHALL BE MADE TO APPLY CONTINUOUSLY AND NOT BE LIMITED TO NORMAL WORKING HOURS.
15. THE CONTRACTOR SHALL CONDUCT WORK ALONG ANY SECTION OF THIS PROJECT WHICH IS CROSSED BY, OR ADJACENT TO, A PUBLIC UTILITY SUCH AS HIGH POWER LINES, WATER LINES, ETC. IN SUCH A MANNER THAT NO DAMAGE RESULTS TO THESE UTILITIES. THE CONTRACTOR WILL BE HELD SOLELY RESPONSIBLE FOR DAMAGE TO SUCH UTILITIES AS A RESULT OF CARELESS OR NEGLIGENT OPERATIONS.

16. THE CONTRACTOR SHALL POST EMERGENCY TELEPHONE NUMBERS AT THE JOB SITE FOR PUBLIC WORKS, AMBULANCE, POLICE AND FIRE DEPARTMENTS.
17. ALL POLES, WIRE, CABLES, CONDUITS, PIPELINES, OR OTHER STRUCTURES WITHIN THE WORK AREA BELONGING TO MUNICIPALITIES OR PUBLIC UTILITY CORPORATIONS SHALL BE PROTECTED BY THE CONTRACTOR.
18. EXISTING SIDEWALK, CURB AND GUTTER DAMAGED OR DISPLACED BY THE CONTRACTOR'S OPERATION SHALL BE REPAIRED OR REPLACED BY THE CONTRACTOR AT THE CONTRACTOR'S EXPENSE.
19. THE CONTRACTOR SHALL CONDUCT HIS WORK IN SUCH A MANNER AS TO NOT INTERFERE OR BLOCK EXISTING DRAINAGE. THE MANNER OF MAINTAINING DRAINAGE SHALL BE APPROVED BY THE ENGINEER.
20. THE CONTRACTOR SHALL NOTIFY THE CITY OF ANTIOCH 48 HOURS PRIOR TO REQUIRING INSPECTION SERVICES.
21. FOR DETAILS NOT SHOWN ON THESE PLANS, REFER TO THE PROJECT SPECIFICATIONS AND CONSTRUCTION DETAILS.
22. THE CONTRACTOR SHALL BE RESPONSIBLE FOR ALL LIGHTS, SIGNS, BARRICADES, FLAGGERS OR ANY OTHER DEVICES NECESSARY TO PROVIDE FOR THE PUBLIC SAFETY, AND SHALL SUBMIT TRAFFIC CONTROL PLANS TO THE ENGINEER FOR APPROVAL PRIOR TO BEGINNING WORK.
23. THE CONTRACTOR SHALL NOT DESTROY ANY PERMANENT SURVEY POINTS WITHOUT THE APPROVAL OF THE ENGINEER. ANY PERMANENT MONUMENTS OR POINTS DESTROYED SHALL BE REPLACED BY A LICENSED ENGINEER OR SURVEYOR AT THE CONTRACTOR'S EXPENSE.

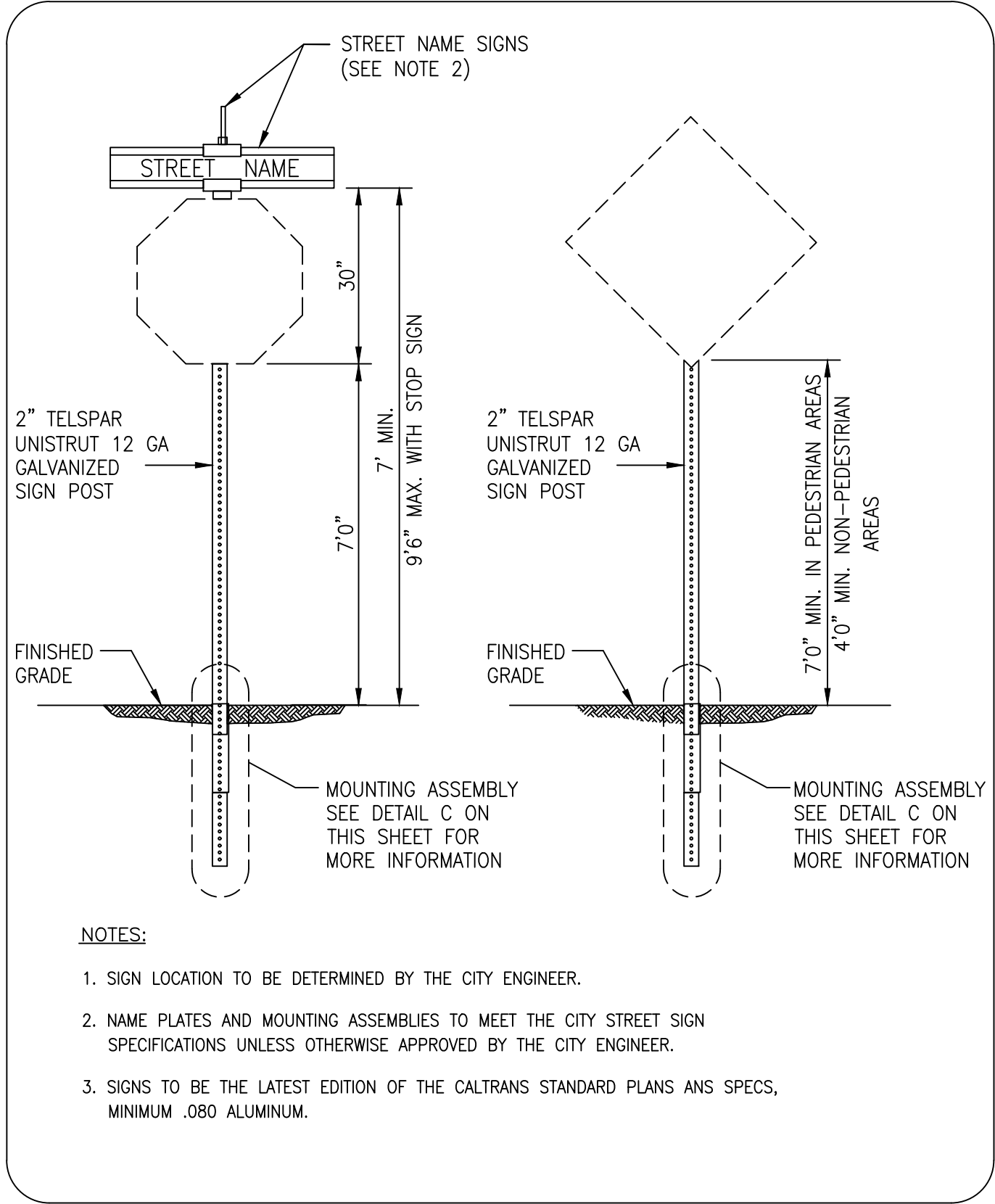

B STREET NAME AND TRAFFIC SIGNS
NOT TO SCALE

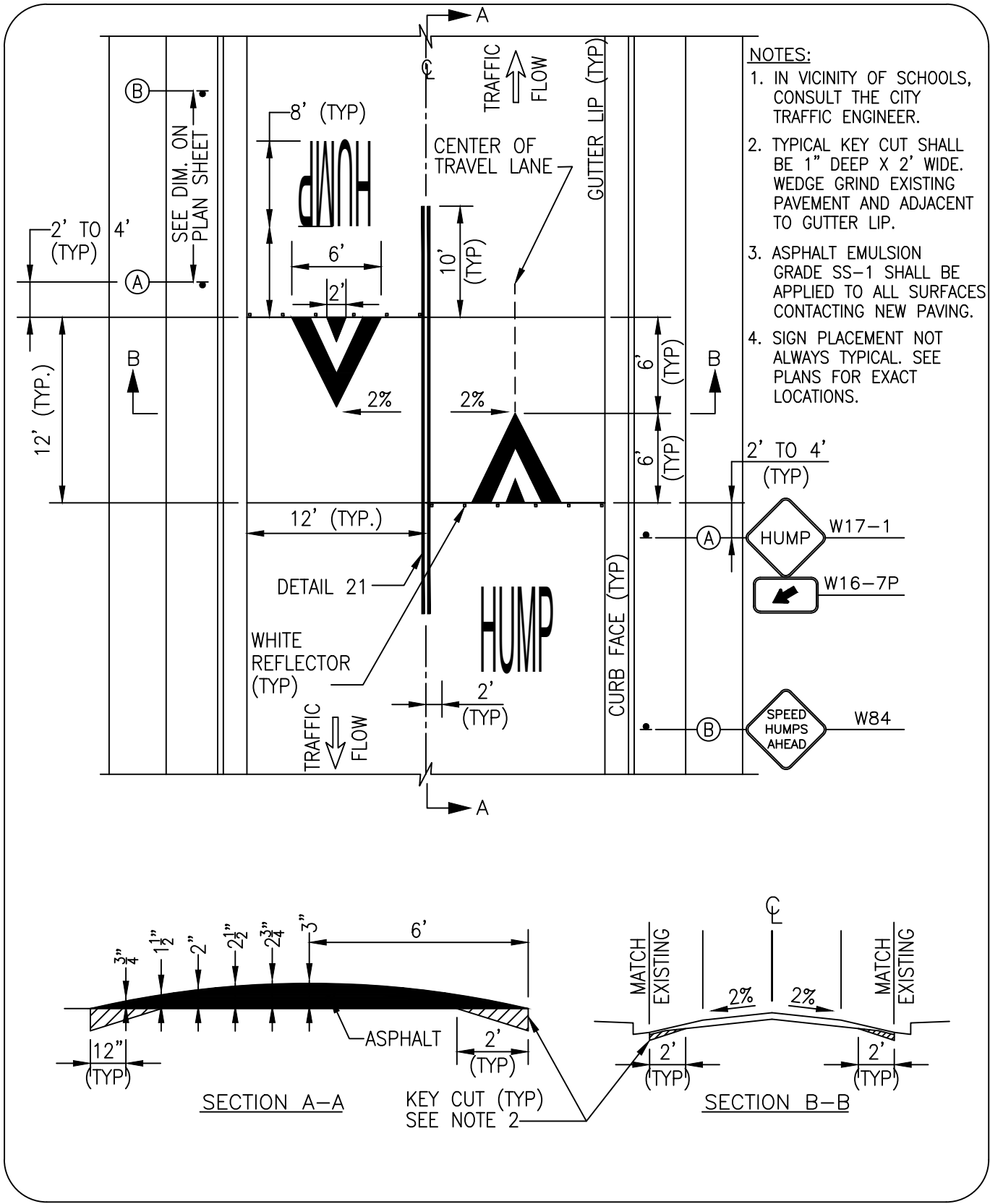

A SPEED HUMP
NOT TO SCALE

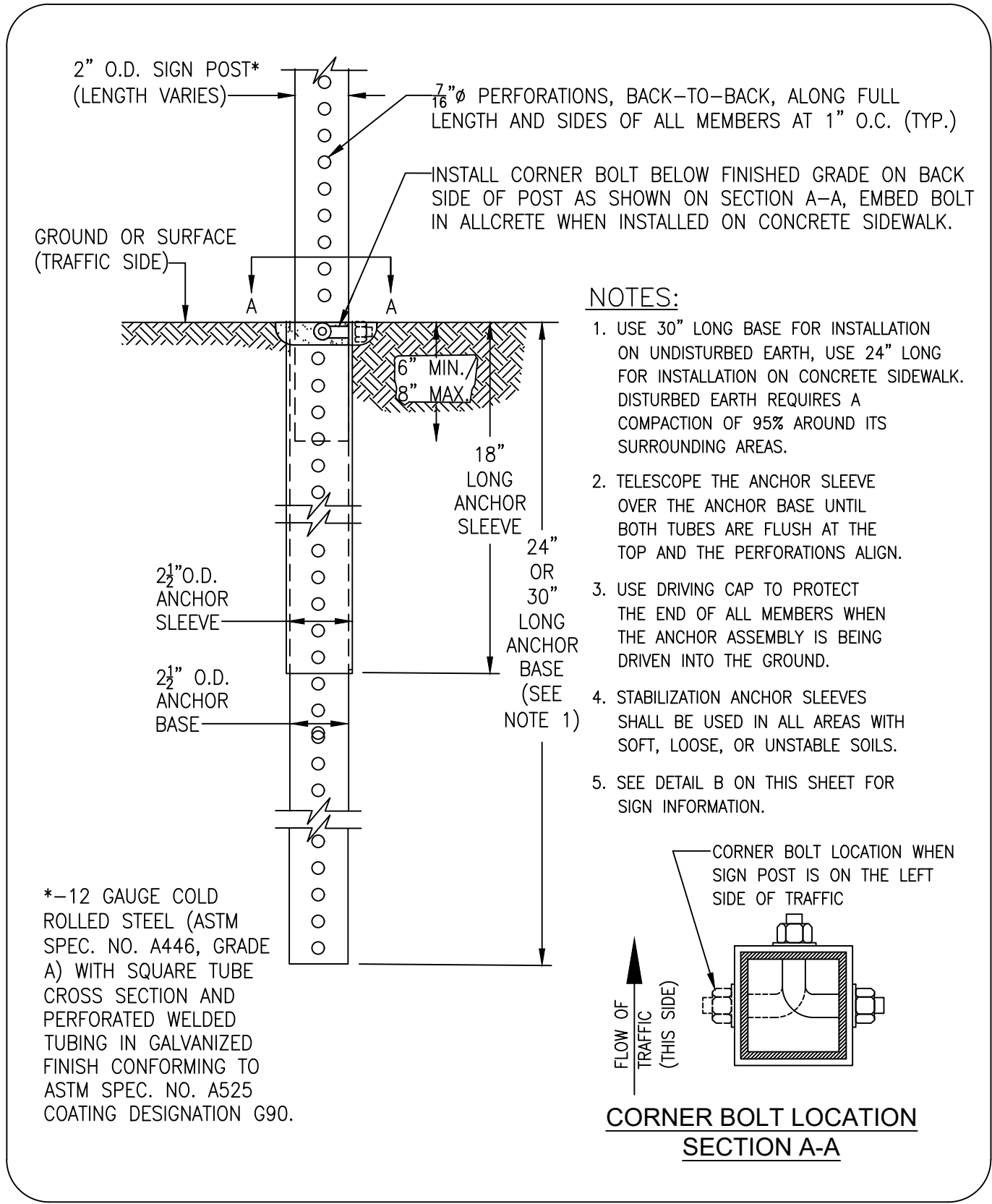

C STREET NAME AND TRAFFIC SIGNS
NOT TO SCALE



ANTIOCH
CALIFORNIA
OPPORTUNITY LIVES HERE

AS BUILT

DATE ACCEPTED: _____
INSPECTED BY: _____
AS BUILT REVISIONS: _____
DATE: _____
BY: _____

DATE: 3/6/23			
DESIGNED BY: CS			
CHECKED BY: NJ			
DRAWN BY: SJ			
REVISIONS:	NO.	BY	DATE

PUBLIC WORKS DEPARTMENT CAPITAL IMPROVEMENTS DIVISION	SCALE: NTS
	PUBLIC WORKS PROJECT NO. PW 242-19A
NEIGHBORHOOD TRAFFIC CALMING PROJECT GENERAL NOTES & DETAILS	SHEET 2
	OF 14 SHEETS

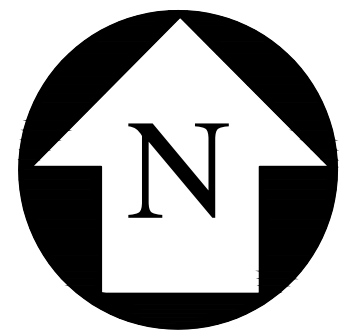

2nd Street

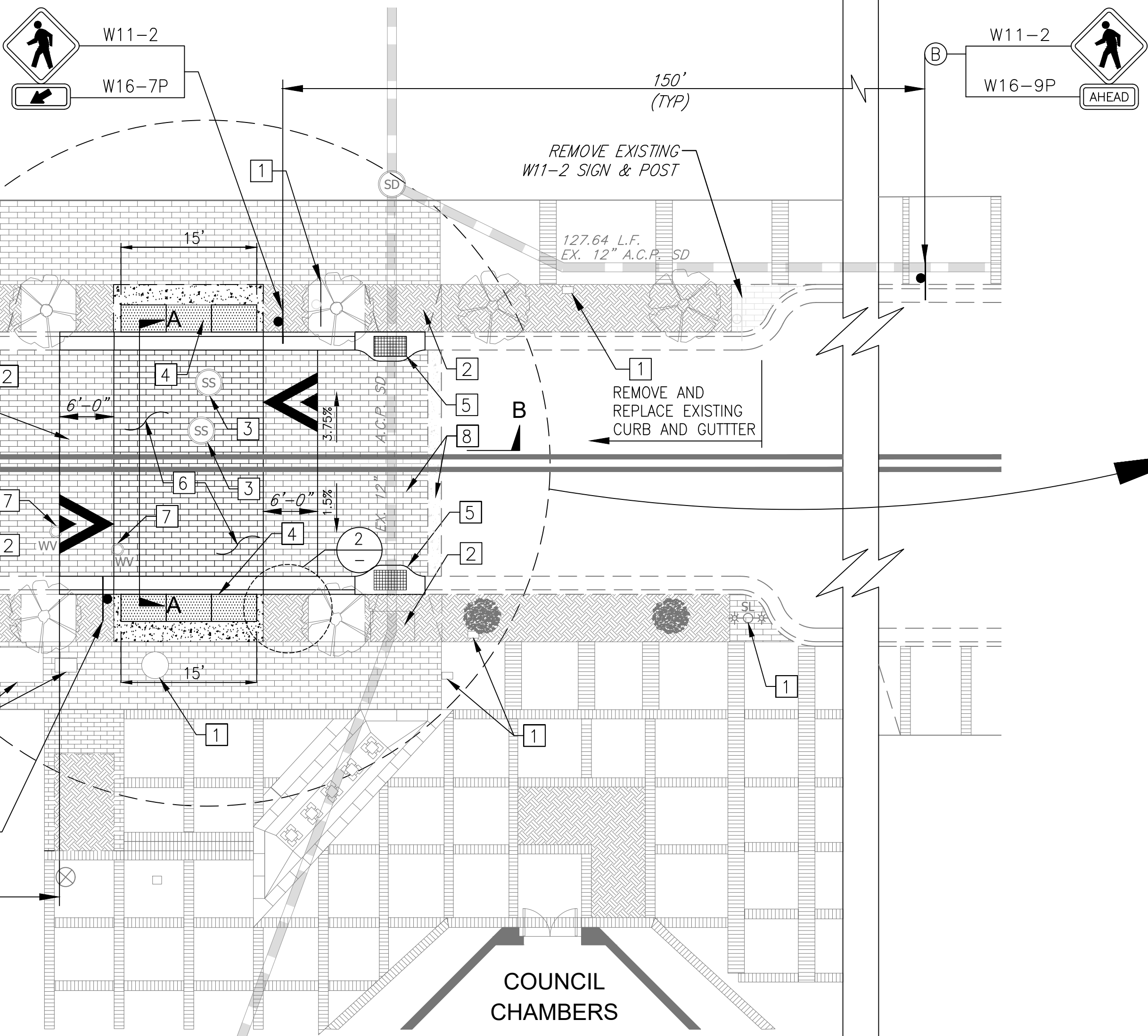

LAYOUT PLAN
SCALE: 1" = 10'

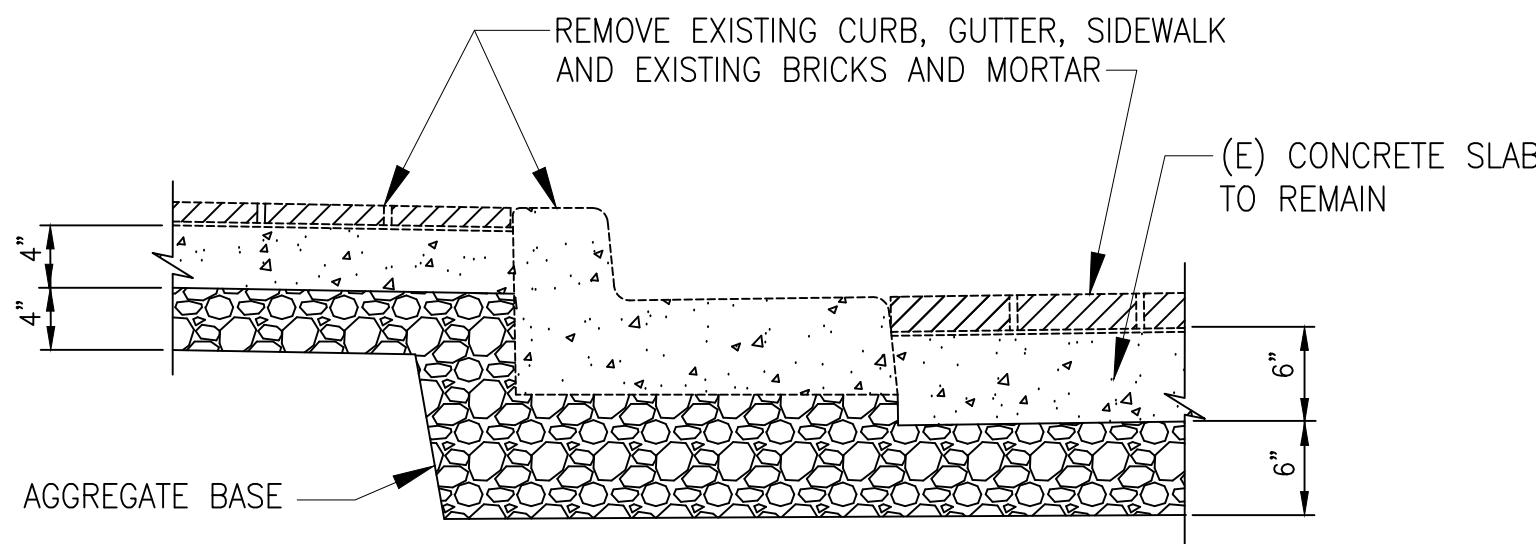
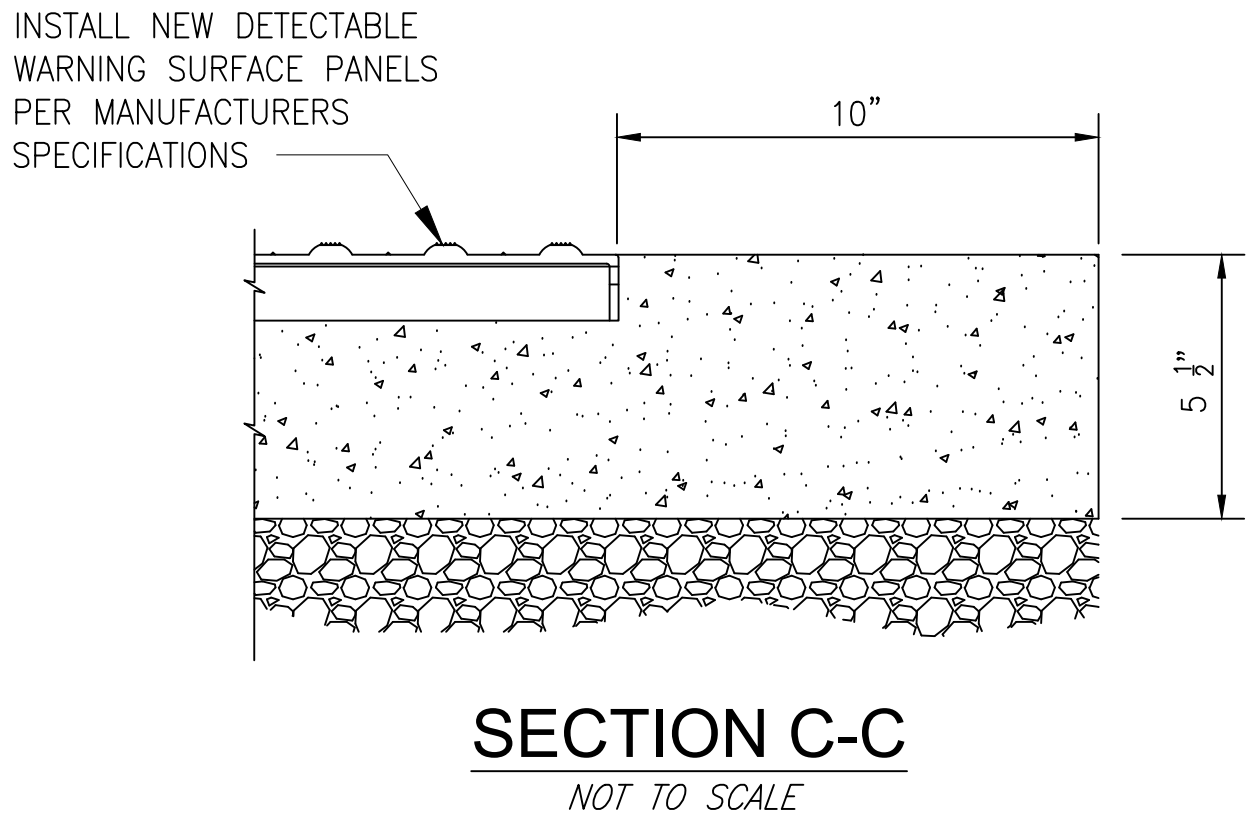
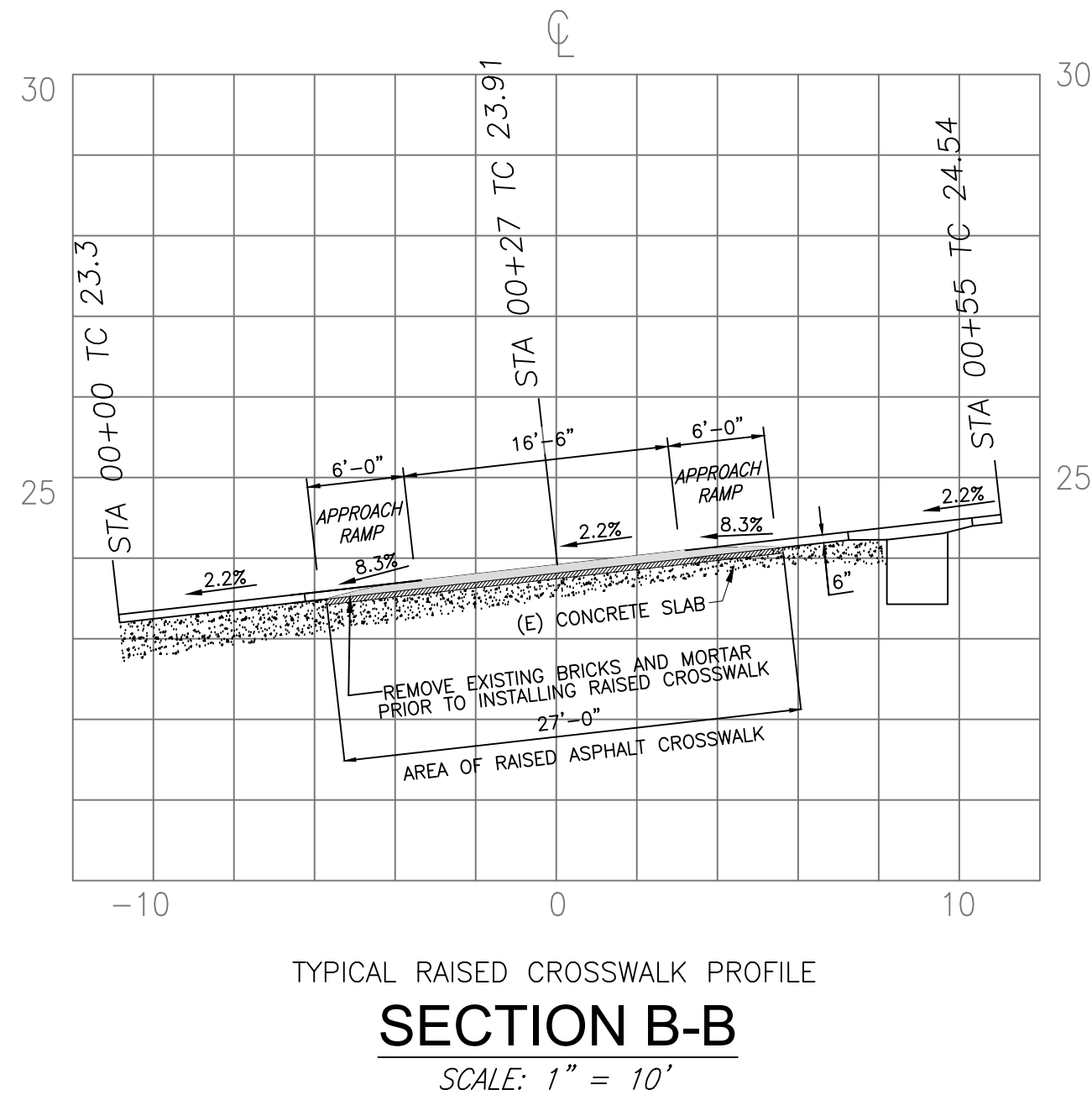
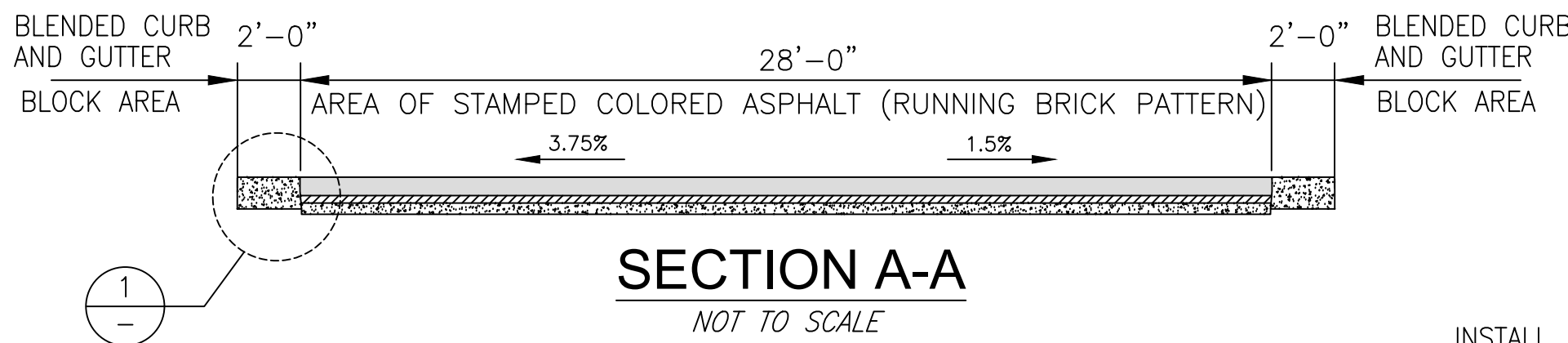

SECTION AT EXISTING CURB AND GUTTER
NOT TO SCALE

NOTES:

- ALL NEW CONCRETE SHALL BE CONNECTED TO EXISTING CONCRETE BY DOWELING.
- EXISTING CURB AND GUTTER - USE EIGHTEEN INCH (18") LONG #4 BARS EMBEDDED 9" INTO EACH END OF EXISTING CURB AND GUTTER.
- EXISTING SIDEWALK AND DRIVEWAY - USE EIGHTEEN INCHES (18") LONG #4 BARS SPACED AT EIGHTEEN INCHES (18") ON CENTERS. NINE INCHES (9") SHALL BE DOWELED INTO EXISTING SIDEWALK AND DRIVEWAY.

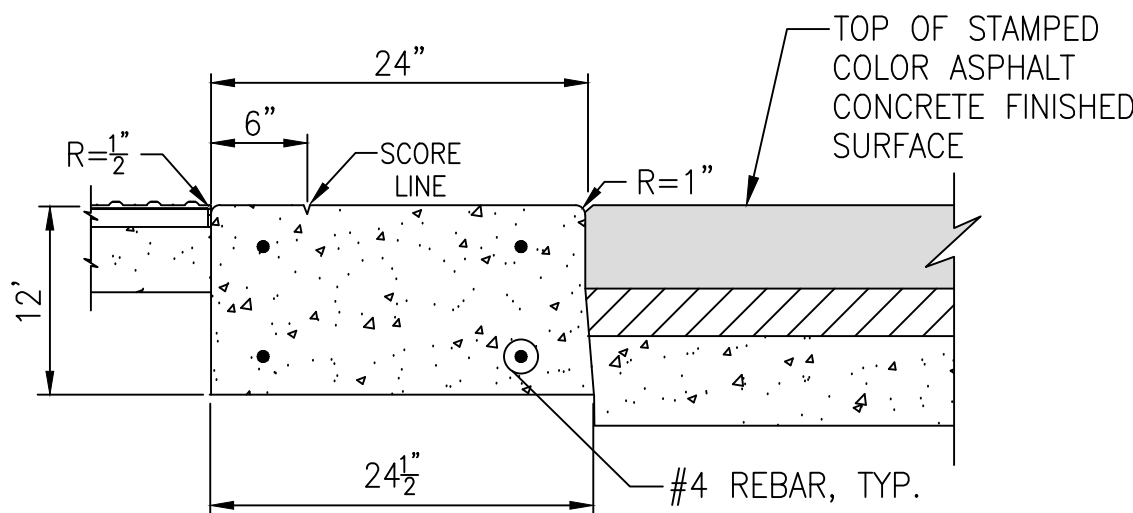

ALL CONCRETE TO BE CLASS 3 CONCRETE
BLENDED CURB AND GUTTER BLOCK

DETAIL 1
NOT TO SCALE

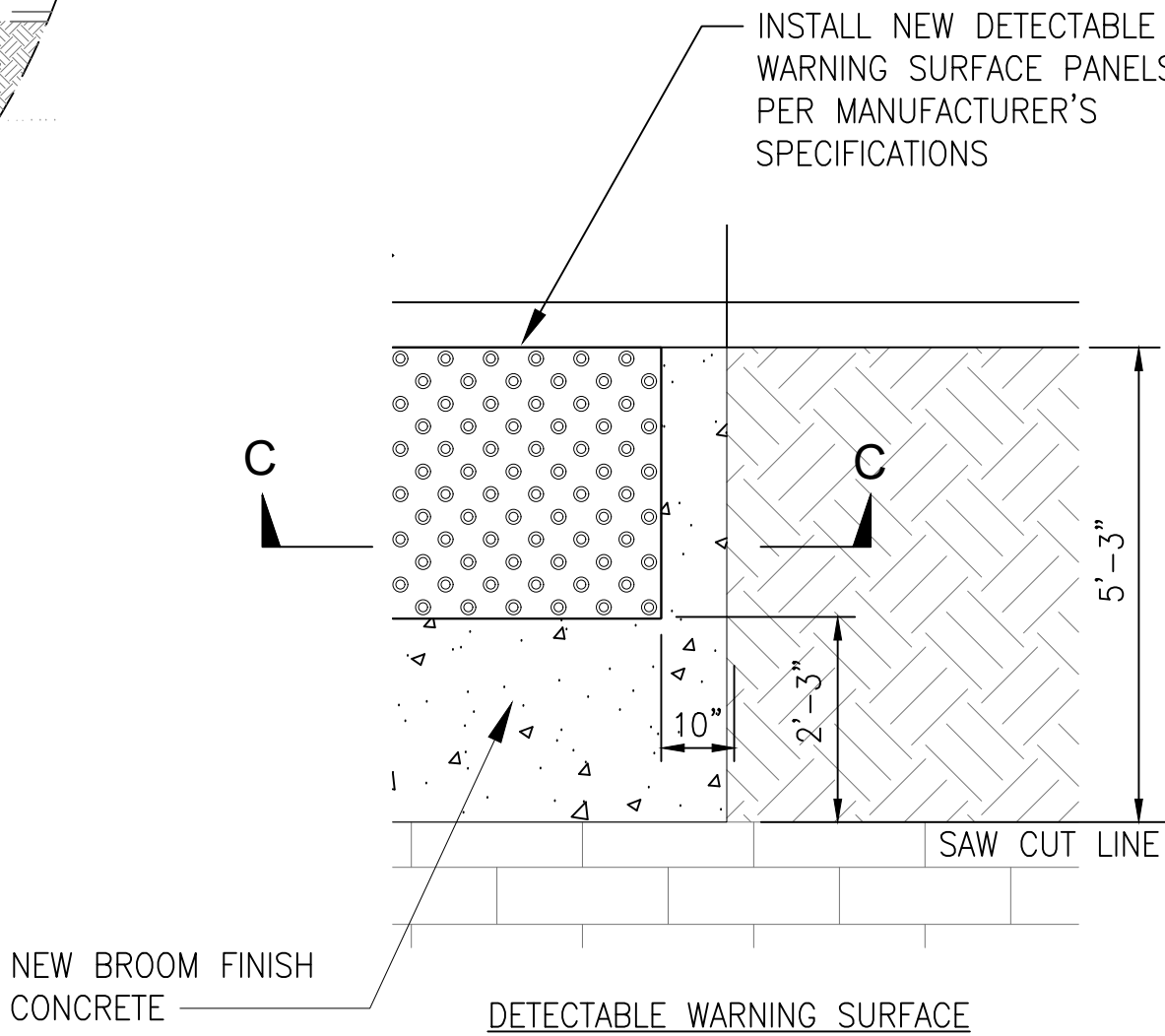

DETAIL 2
NOT TO SCALE

CONSTRUCTION NOTES

- PROTECT IN PLACE.
- REMOVE EXISTING CURB RAMP, REPLACE CURB AND GUTTER PER CITY'S CONSTRUCTION DETAILS. INSTALL MULCH.
- PROTECT EXISTING SEWER MANHOLE AND RAISE MANHOLE TO FINISHED AFTER CONSTRUCTION OF RAISED CROSSWALK.
- REMOVE AND REPLACE EXISTING SIDEWALK AND WET SET RAISED DETECTABLE SURFACE PANELS PER MANUFACTURERS RECOMMENDATIONS 60"x36" PANELS FOR A TOTAL WIDTH OF 15'-0", TYP.
- INSTALL NEW CATCH BASIN PER CITY OF ANTIOCH PLAN NO. SD-04 AS ON EXISTING STORM DRAIN PIPE.
- CONSTRUCT RAISED CROSSWALK PER DETAIL ON THIS SHEET.
- PROTECT EXISTING WATER VALVE AND RAISE LID TO FINISHED GRADE CONSTRUCTION OF RAISED CROSSWALK.
- REMOVE EXISTING BRICKS AND CONCRETE BAND AND PAVE ENTIRE AREA.



ANTIOCH
CALIFORNIA
OPPORTUNITY LIVES HERE

AS BUILT

DATE ACCEPTED: _____
INSPECTED BY: _____
AS BUILT REVISIONS: _____
DATE: _____
BY: _____

DATE: 3/6/23				
DESIGNED BY: CS				
CHECKED BY: NJ				
DRAWN BY: CS				
REVISIONS:	NO.	BY	DATE	

PUBLIC WORKS DEPARTMENT CAPITAL IMPROVEMENTS DIVISION	SCALE: AS NOTED PUBLIC WORKS PROJECT NO. PW 242-19A
NEIGHBORHOOD TRAFFIC CALMING PROJECT 2ND STREET	SHEET 3 OF 14 SHEETS

TULIP DRIVE

SCALE: 1" = 40'



CONSTRUCTION NOTES:

- ① CONSTRUCT SPEED HUMP, INSTALL PAVEMENT MARKINGS, STRIPING AND SIGNS PER DETAILS "A", "B", AND "C" ON SHEET 2. REMOVE ALL CONFLICTING STRIPING.

ANTIOCH
CALIFORNIA
OPPORTUNITY LIVES HERE

AS BUILT

DATE ACCEPTED: _____
INSPECTED BY: _____
AS BUILT REVISIONS: _____
DATE: _____
BY: _____

DATE: 3/6/23			
DESIGNED BY: CS			
CHECKED BY: NJ			
DRAWN BY: SJ			
REVISIONS:	NO.	BY	DATE

PUBLIC WORKS DEPARTMENT
CAPITAL IMPROVEMENTS DIVISION

NEIGHBORHOOD TRAFFIC CALMING PROJECT
TULIP DRIVE

SCALE: 1"=40'
PUBLIC WORKS
PROJECT NO.
PW 242-19A
SHEET 4
OF 14 SHEETS



GENTRYTOWN DRIVE (1)
SCALE: 1" = 40'



CONSTRUCTION NOTES:

① CONSTRUCT SPEED HUMP, INSTALL PAVEMENT MARKINGS, STRIPING AND SIGNS PER DETAILS "A", "B", AND "C" ON SHEET 3. REMOVE ALL CONFLICTING STRIPING.

ANTIOCH
CALIFORNIA
OPPORTUNITY LIVES HERE

AS BUILT			
DATE ACCEPTED: _____			
INSPECTED BY: _____			
AS BUILT REVISIONS:			
DATE: _____			
BY: _____			

DATE: 3/6/23			
DESIGNED BY: CS			
CHECKED BY: NJ			
DRAWN BY: SJ			
REVISIONS:	NO.	BY	DATE

PUBLIC WORKS DEPARTMENT CAPITAL IMPROVEMENTS DIVISION	
NEIGHBORHOOD TRAFFIC CALMING PROJECT GENTRYTOWN DRIVE (1)	

SCALE: 1"=40'
PUBLIC WORKS PROJECT NO. PW 242-19A
SHEET 5
OF 14 SHEETS

GENTRYTOWN DRIVE (2)

SCALE: 1" = 40'



CONSTRUCTION NOTES:

- ① CONSTRUCT SPEED HUMP, INSTALL PAVEMENT MARKINGS, STRIPING AND SIGNS PER DETAILS "A", "B", AND "C" ON SHEET 2. REMOVE ALL CONFLICTING STRIPING.

ANTIOCH
CALIFORNIA
OPPORTUNITY LIVES HERE

AS BUILT

DATE ACCEPTED: _____
INSPECTED BY: _____
AS BUILT REVISIONS: _____
DATE: _____
BY: _____

DATE: 3/6/23			
DESIGNED BY: CS			
CHECKED BY: NJ			
DRAWN BY: SJ			
REVISIONS:	NO.	BY	DATE

PUBLIC WORKS DEPARTMENT
CAPITAL IMPROVEMENTS DIVISION

NEIGHBORHOOD TRAFFIC CALMING PROJECT
GENTRYTOWN DRIVE (2)

SCALE: 1"=40'
PUBLIC WORKS
PROJECT NO.
PW 242-19A
SHEET 6
OF 14 SHEETS

LONGVIEW DRIVE

SCALE: 1" = 40'



MATCHLINE A - SEE ABOVE

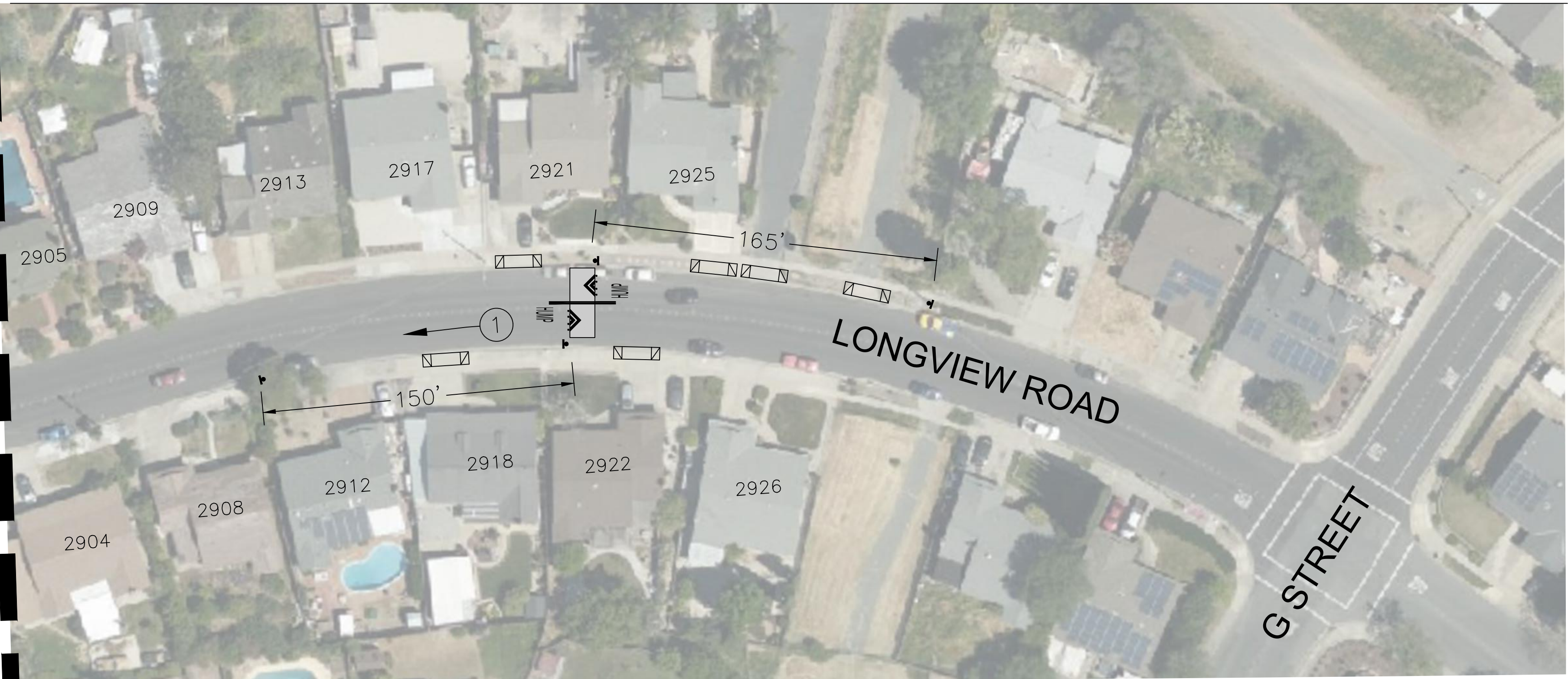

CONSTRUCTION NOTES:

- ① CONSTRUCT SPEED HUMP, INSTALL PAVEMENT MARKINGS, STRIPING AND SIGNS PER DETAILS "A", "B", AND "C" ON SHEET 2. REMOVE ALL CONFLICTING STRIPING.

ANTIOCH
CALIFORNIA
OPPORTUNITY LIVES HERE

AS BUILT

DATE ACCEPTED: _____
INSPECTED BY: _____
AS BUILT REVISIONS:
DATE: _____
BY: _____

DATE: 3/6/23			
DESIGNED BY: CS			
CHECKED BY: NJ			
DRAWN BY: SJ			
REVISIONS:	NO.	BY	DATE

PUBLIC WORKS DEPARTMENT
CAPITAL IMPROVEMENTS DIVISION

NEIGHBORHOOD TRAFFIC CALMING PROJECT
LONGVIEW ROAD

SCALE: 1"=40'
PUBLIC WORKS
PROJECT NO.
PW 242-19A
SHEET 7
OF 14 SHEETS

CLEARBROOK DRIVE

SCALE: 1" = 40'



CONSTRUCTION NOTES:

- ① CONSTRUCT SPEED HUMP, INSTALL PAVEMENT MARKINGS, STRIPING AND SIGNS PER DETAILS "A", "B", AND "C" ON SHEET 2. REMOVE ALL CONFLICTING STRIPING.

ANTIOCH
CALIFORNIA
OPPORTUNITY LIVES HERE

AS BUILT

DATE ACCEPTED: _____
INSPECTED BY: _____
AS BUILT REVISIONS: _____
DATE: _____
BY: _____

DATE: 3/6/23			
DESIGNED BY: CS			
CHECKED BY: NJ			
DRAWN BY: SJ			
REVISIONS:	NO.	BY	DATE

PUBLIC WORKS DEPARTMENT
CAPITAL IMPROVEMENTS DIVISION

NEIGHBORHOOD TRAFFIC CALMING PROJECT
CLEARBROOK ROAD

SCALE: 1"=40'
PUBLIC WORKS
PROJECT NO.
PW 242-19A
SHEET 8
OF 14 SHEETS



Know what's below.
Call before you dig.

GARROW DRIVE
SCALE: 1" = 40'

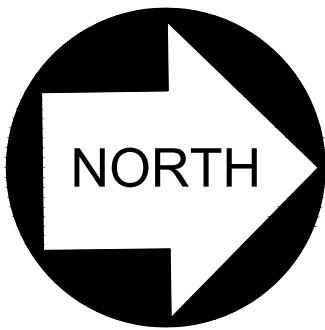

CONSTRUCTION NOTES:

- ① CONSTRUCT SPEED HUMP, INSTALL PAVEMENT MARKINGS, STRIPING AND SIGNS PER DETAILS "A", "B", AND "C" ON SHEET 2. REMOVE ALL CONFLICTING STRIPING.

ANTIOCH
CALIFORNIA
OPPORTUNITY LIVES HERE

AS BUILT

DATE ACCEPTED: _____
INSPECTED BY: _____
AS BUILT REVISIONS: _____
DATE: _____
BY: _____

DATE: 3/6/23			
DESIGNED BY: CS			
CHECKED BY: NJ			
DRAWN BY: SJ			
REVISIONS:	NO.	BY	DATE

PUBLIC WORKS DEPARTMENT CAPITAL IMPROVEMENTS DIVISION		SCALE: 1"=40'
NEIGHBORHOOD TRAFFIC CALMING PROJECT GARROW DRIVE		PUBLIC WORKS PROJECT NO. PW 242-19A
		SHEET 9
		OF 14 SHEETS

ASILOMAR DRIVE

SCALE: 1" = 40'



Know what's below.
Call before you dig.

CONSTRUCTION NOTES:

- ① CONSTRUCT SPEED HUMP, INSTALL PAVEMENT MARKINGS, STRIPING AND SIGNS PER DETAILS "A", "B", AND "C" ON SHEET 2. REMOVE ALL CONFLICTING STRIPING.



ANTIOCH
CALIFORNIA
OPPORTUNITY LIVES HERE

AS BUILT

DATE ACCEPTED: _____
INSPECTED BY: _____
AS BUILT REVISIONS: _____
DATE: _____
BY: _____

DATE: 3/6/23			
DESIGNED BY: SJ			
CHECKED BY: CS			
DRAWN BY: SJ			
REVISIONS:	NO.	BY	DATE

PUBLIC WORKS DEPARTMENT
CAPITAL IMPROVEMENTS DIVISION

NEIGHBORHOOD TRAFFIC CALMING PROJECT
ASILOMAR DRIVE

SCALE: 1"=40'
PUBLIC WORKS
PROJECT NO.
PW 242-19A
SHEET 10
OF 14 SHEETS

PREWETT RANCH DRIVE (1)

SCALE: 1" = 40'



MATCHLINE A - SEE BELOW

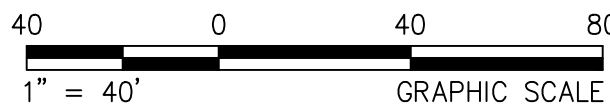
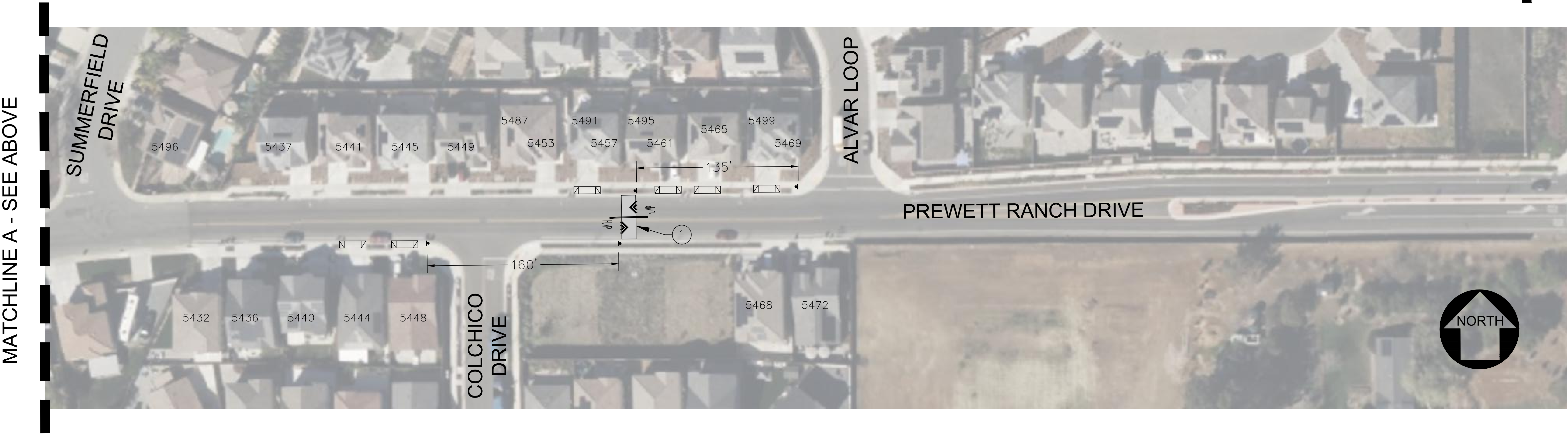

CONSTRUCTION NOTES:

- ① CONSTRUCT SPEED HUMP, INSTALL PAVEMENT MARKINGS, STRIPING AND SIGNS PER DETAILS "A", "B", AND "C" ON SHEET 2. REMOVE ALL CONFLICTING STRIPING.

ANTIPOCH
CALIFORNIA
OPPORTUNITY LIVES HERE

AS BUILT

DATE ACCEPTED: _____
INSPECTED BY: _____
AS BUILT REVISIONS:
DATE: _____
BY: _____

DATE: 3/6/23			
DESIGNED BY: CS			
CHECKED BY: NJ			
DRAWN BY: SJ			
REVISIONS:	NO.	BY	DATE

PUBLIC WORKS DEPARTMENT
CAPITAL IMPROVEMENTS DIVISION

NEIGHBORHOOD TRAFFIC CALMING PROJECT
PREWETT RANCH DRIVE (1)

SCALE: 1"=40'
PUBLIC WORKS
PROJECT NO.
PW 242-19A
SHEET 11
OF 14 SHEETS

PREWETT RANCH DRIVE (2)

SCALE: 1" = 40'

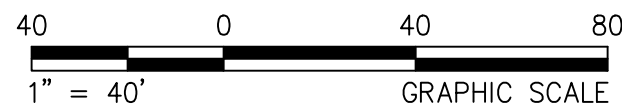

CONSTRUCTION NOTES:

- ① CONSTRUCT SPEED HUMP, INSTALL PAVEMENT MARKINGS, STRIPING AND SIGNS PER DETAILS "A", "B", AND "C" ON SHEET 2. REMOVE ALL CONFLICTING STRIPING.

ANTIPOCH
CALIFORNIA
OPPORTUNITY LIVES HERE

AS BUILT

DATE ACCEPTED: _____
INSPECTED BY: _____
AS BUILT REVISIONS: _____
DATE: _____
BY: _____

DATE: 3/6/23			
DESIGNED BY: SJ			
CHECKED BY: CS			
DRAWN BY: SJ			
REVISIONS:	NO.	BY	DATE

PUBLIC WORKS DEPARTMENT
CAPITAL IMPROVEMENTS DIVISION

NEIGHBORHOOD TRAFFIC CALMING PROJECT
PREWETT RANCH DRIVE (2)

SCALE: 1"=40'
PUBLIC WORKS
PROJECT NO.
PW 242-19A
SHEET 12
OF 14 SHEETS

COUNTRY HILLS DRIVE

SCALE: 1" = 40'



CONSTRUCTION NOTES:

- ① CONSTRUCT SPEED HUMP, INSTALL PAVEMENT MARKINGS, STRIPING AND SIGNS PER DETAILS "A", "B", AND "C" ON SHEET 2. REMOVE ALL CONFLICTING STRIPING.

ANTIOCH
CALIFORNIA
OPPORTUNITY LIVES HERE

AS BUILT

DATE ACCEPTED: _____
INSPECTED BY: _____
AS BUILT REVISIONS: _____
DATE: _____
BY: _____

DATE: 3/6/23			
DESIGNED BY: SJ			
CHECKED BY: CS			
DRAWN BY: SJ			
REVISIONS:	NO.	BY	DATE

PUBLIC WORKS DEPARTMENT
CAPITAL IMPROVEMENTS DIVISION

NEIGHBORHOOD TRAFFIC CALMING PROJECT
COUNTRY HILLS DRIVE

SCALE: 1"=40'
PUBLIC WORKS
PROJECT NO.
PW 242-19A
SHEET 13
OF 14 SHEETS

DEERFIELD DRIVE
SCALE: 1" = 40'

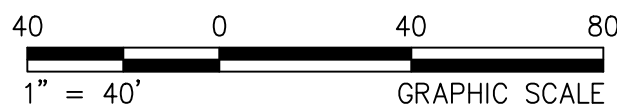
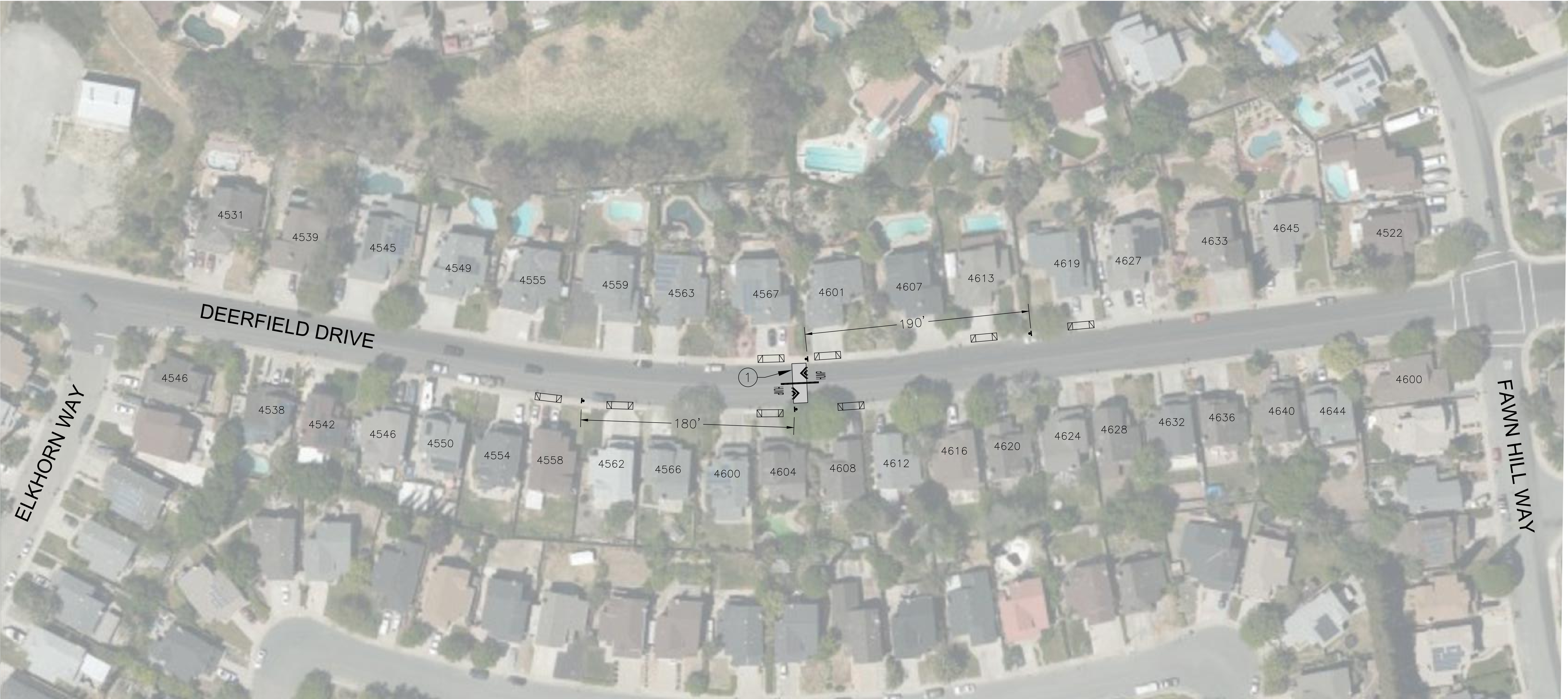
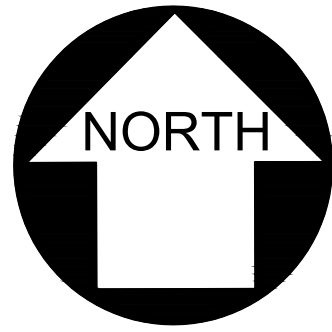

CONSTRUCTION NOTES:

① CONSTRUCT SPEED HUMP, INSTALL PAVEMENT MARKINGS, STRIPING AND SIGNS PER DETAILS "A", "B", AND "C" ON SHEET 2. REMOVE ALL CONFLICTING STRIPING.

ANTIOCH
CALIFORNIA
OPPORTUNITY LIVES HERE

AS BUILT

DATE ACCEPTED: _____
INSPECTED BY: _____
AS BUILT REVISIONS: _____
DATE: _____
BY: _____

DATE: 3/6/23			
DESIGNED BY: CS			
CHECKED BY: NJ			
DRAWN BY: SJ			
REVISIONS:	NO.	BY	DATE

PUBLIC WORKS DEPARTMENT
CAPITAL IMPROVEMENTS DIVISION

NEIGHBORHOOD TRAFFIC CALMING PROJECT
DEERFIELD DRIVE

SCALE: 1"=40'
PUBLIC WORKS
PROJECT NO.
PW 242-19A

SHEET 14

OF 14 SHEETS